

# COATC Traffic and Parking Regulations

## OBJECTIVE:

- Provide a safe environment for both pedestrians and motorist.
- Establish guidelines for orderly use and parking of all motor vehicles on campus.

## POLICY:

- Drivers shall obey all posted speed limits and traffic signage. Failure to comply with posted traffic control signage may result in a traffic citation being issued by the City of Heath Police Department.
- Vehicles must travel with established traffic flows as indicated by white directional arrows painted on the pavement.
- Drivers must yield to the right when encountering emergency response vehicles.
- Unauthorized use of reserved parking areas is prohibited. Noncompliance with this rule will result in the towing and impoundment of the vehicle at the owner's expense.
- Temporary or permanent handicap-parking passes should be prominently displayed on the vehicle. All violators will be ticketed and towed. Employees desiring information concerning handicap-parking passes should contact the Department of Motor Vehicles.
- Drivers must yield to pedestrians at all times.
- Vehicles parked in loading zones shall not exceed the posted time limits and shall display **flashers** where appropriate.
- No pull through parking is permitted in diagonal parking spaces.
- Authorized parking areas are marked; all other paved and unpaved areas are off limits except for maintenance activities.
- Any vehicles left unattended for a period of seventy-two (72) hours will be considered abandoned for purpose of towing and impoundment at owner's expense. Extended parking will be allowed upon request.
- Vehicles that exhibit noticeable fuel leakage will be required to vacate the site until repairs have been made.
- During inclement weather, drivers are asked to proceed with caution and reduce speed.
- Rearrangement of parking areas can be established for, but not limited to any of the following reasons: Special Events, Snow Operations, Construction Activities, and Security Measures.
- During periods of elevated security at the site, visitors to COATC may be limited to parking in designated areas unless prior arrangements have been made. Additionally, the use of checkpoints may be utilized to ascertain purpose of visit.
- A sticker notification will be utilized in the enforcement of these rules.
- Overnight parking of RVs is prohibited under this policy. Vehicles with boats, trailers or campers in tow, must park in the "Pit" parking area and only after notification to and acceptance by the Port Authority in advance.
- Notification must be made to the Port Authority before large commercial vehicles are left unattended on site. Failure to comply with this provision may result in towing at the owner's expense

  
\_\_\_\_\_/ Date 7/5/12  
Rick Platt, President and CEO

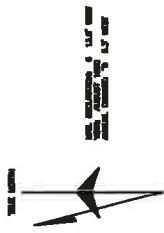
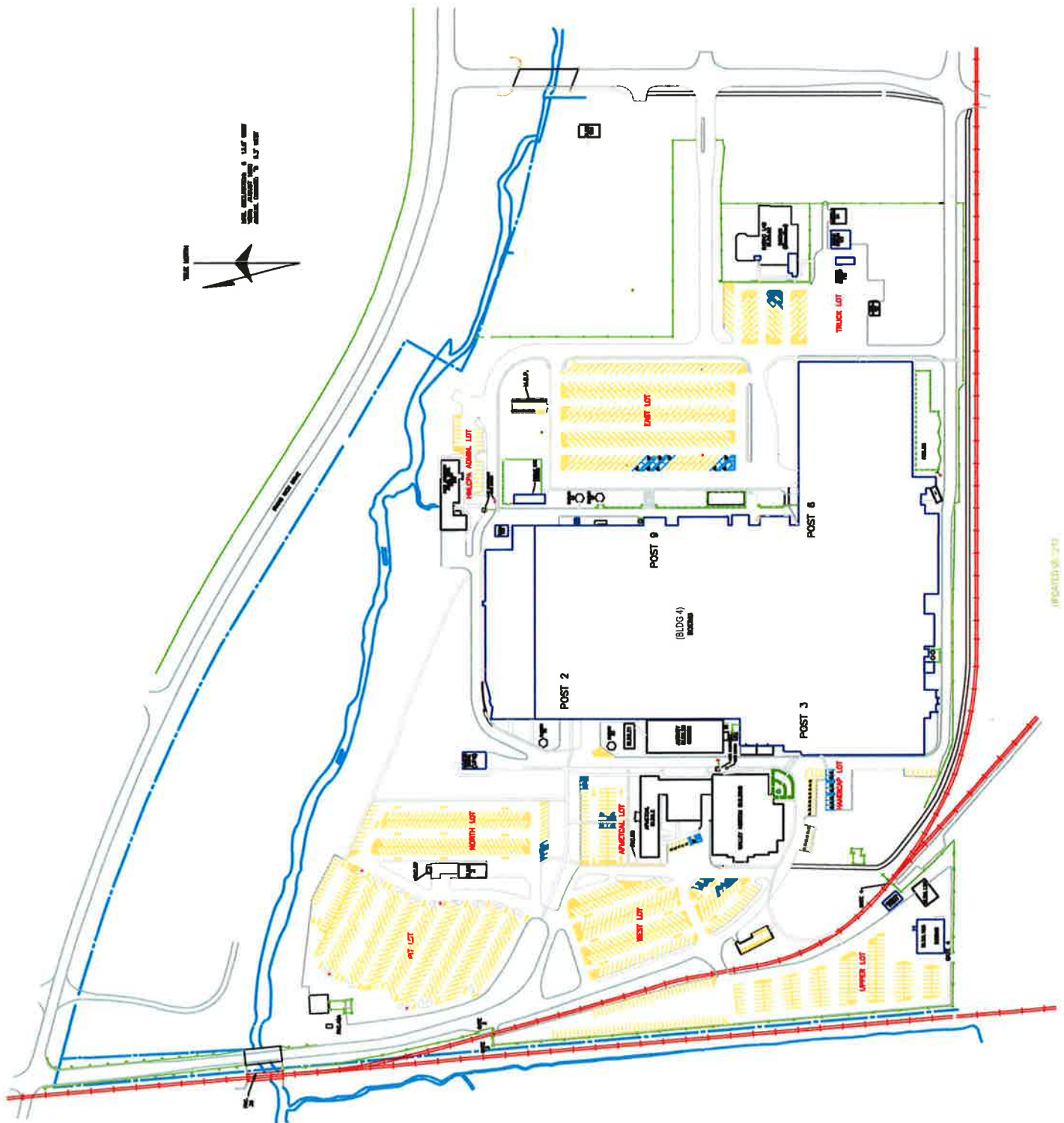

INCHES TO FEET